

With integrated PSU adapter, not visible after installation.

**AVAILABLE COLOURS**



Nr	Housing	Front ring
XX=61	Matt white RAL 9016	Gold
XX=62	Matt white RAL 9016	Black
XX=65	Matt white RAL 9016	White
XX=71	Matt black RAL 9005	Gold
XX=72	Matt black RAL 9005	Black
XX=76	Matt black RAL 9005	White

## Odion XS (Gen2)

### SPECIFICATIONS

Beam angle (FWHM)	18° / 37° / 60° (80° on request)
UGR (4H8H 70/50/20)	<19 (18° + 37°)
Fixture material	Die cast aluminium / Polycarbonate
Environment	Indoor
IK rate	IK03
Operating temperature (Ta)	-20°C / +45°C <sup>1</sup>
Safety marks	EN60598 / EN62031 / EN 62471
EMC compliance	EN55015
Colour consistency (SDCM)	MacAdam step 3
Warranty	7 years * (within the European Union and the countries of the Free Trade Association for products delivered after 1 May 2015)
Energy class	A+

This luminaire contains built-in LED lamps. There are no exchangeable parts inside the luminaire. EU 874/2012

<sup>1</sup> In applications with a flat roof (f.i. car showrooms) the temperatures may exceed 45°C. Please ask our sales office for a special driver.



Ask our sales department about the possibilities for:  
- Extra LED options from the LUXEON Stylist Series

IP20

## CRI80/97 VARIATIONS

Odion XS LV 3000K CRI80 3000LM	page 3
Odion XS LV 4000K CRI80 3400LM	page 3
Odion XS LV 3000K CRI97 2150LM	page 3
Odion XS LV 3000K CRI97 3000LM	page 3

## CRI80/97 CHOOSE YOUR LV LUMEN OUTPUT

	mA	W	Lumen Output			Lumen / Watt			Driver types			
			CRI80	CRI80	CRI97	CRI80	CRI80	CRI97	CRI80	CRI97	CRI80/97	CRI80/97
			3000K	4000K	3000K	3000K	4000K	3000K	No dim	No dim	Dali	Casambi
<i>Special request</i>	500	17,9	2250	2500	1450	125	139	81	GA-016	On request	GAC-616	GA
<b>Standard</b>	700	27,0	3000	3400	2150	111	126	80	GA-016	On request	GAC-616	GA
<i>Special request</i>	800	32,1	3400	3750	2500	106	117	78	GA-016	On request	On request	On request
<i>Special request</i>	850	33,9	3550	3900	2600	105	115	77	GA-016	OT FIT 40	On request	On request
<i>Special request</i>	1050	41,7	4200	4700	3000 <sup>1</sup>	101	113	72 <sup>1</sup>	127692 <sup>2</sup>	OT FIT 40	On request	On request

<sup>1</sup> Standard for Odion XS CRI97 no dim. <sup>2</sup> Alternative integrated driver GA-016 G3 on request.

## DIMENSIONS

- 228mm CRI80 + Stylist Series No dim      162mm CRI97 No dim
- 253mm CRI80 + Stylist Series Dali        253mm CRI97 Dali
- 228mm CRI80 + Stylist Series Casambi    228mm CRI97 Casambi

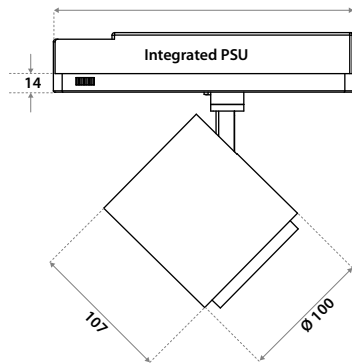

## TRACKS

On request! Ask our sales department about the possibilities.

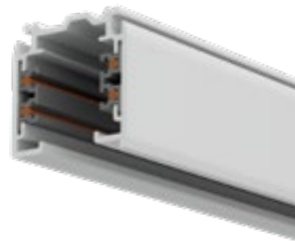

## HONEYCOMB ACCESSORY

Description	Type	Item code
Honeycomb filter	By our assembly	009C03BL0000



Reduces the light output by -25% compared to clear glass.

## ODION XS

**3000K/4000K**

### ITEM SPECIFICATIONS (PART A)

Description	18°		37°		60°		mA
	Item code	UGR	Item code	UGR	Item code	UGR	
Odion XS 3000Lm 3000K CRI80 No dim	350403XXHK02	23.5	350403XXHL02	24.8	350403XXHM02	24.1	700
Odion XS 3000Lm 3000K CRI80 Dali	350403XXE402	23.5	350403XXE502	24.8	350403XXE602	24.1	700
Odion XS 3000Lm 3000K CRI80 Casambi	350403XXJ402	23.5	350403XXJ502	24.8	350403XXJ602	24.1	700
Odion XS 3400Lm 4000K CRI80 No dim	350403XXHN02	24.0	350403XXHP02	25.1	350403XXHQ02	24.5	700
Odion XS 3400Lm 4000K CRI80 Dali	350403XXE702	24.0	350403XXE802	25.1	350403XXE902	24.5	700
Odion XS 3400Lm 4000K CRI80 Casambi	350403XXJ702	24.0	350403XXJ802	25.1	350403XXJ902	24.5	700
Odion XS 3000Lm 3000K CRI97 No dim <sup>1</sup>	350403XXHG02	14.9	350403XXHH02	16.0	350403XXHJ02	20.4	1050
Odion XS 2150Lm 3000K CRI97 Dali	350403XXE102	14.2	350403XXE202	15.2	350403XXE302	19.6	700
Odion XS 2150Lm 3000K CRI97 Casambi	350403XXJ102	14.2	350403XXJ202	15.2	350403XXJ302	19.6	700

### ITEM SPECIFICATIONS (PART A)

Description	W	Lm	Lm/W	CRI (typ.)	Pf	Ripple	Inrush current	B-16A Fuse	Safety class	Energy class
Odion XS 3000Lm 3000K CRI80 No dim	27,0	3000	111	82	0.97	<3%	5A 50µS	50	I	A+
Odion XS 3000Lm 3000K CRI80 Dali	27,0	3000	111	82	0.97	<3%	5A 50µS	50	I	A+
Odion XS 3000Lm 3000K CRI80 Casambi	27,0	3000	111	82	0.97	<3%	5A 50µS	50	I	A+
Odion XS 3400Lm 4000K CRI80 No dim	27,0	3000	126	82	0.97	<3%	5A 50µS	50	I	A+
Odion XS 3400Lm 4000K CRI80 Dali	27,0	3000	126	82	0.97	<3%	5A 50µS	50	I	A+
Odion XS 3400Lm 4000K CRI80 Casambi	27,0	3000	126	82	0.97	<3%	5A 50µS	50	I	A+
Odion XS 3000Lm 3000K CRI97 No dim <sup>1</sup>	41,7	3400	72	97	0.97	<3%	5A 50µS	50	I	A+
Odion XS 2150Lm 3000K CRI97 Dali	27,0	3400	80	97	0.97	<3%	5A 50µS	50	I	A+
Odion XS 2150Lm 3000K CRI97 Casambi	27,0	3400	80	97	0.97	<3%	5A 50µS	50	I	A+

### ITEM SPECIFICATIONS (PART C)

Description	Weight	Dimensions single carton	Quantity per carton	Expected lifespan (25°C)		
				L70B50	L80B50	L90B50
Odion XS	840 gr	251x241x123 mm	12 pcs	70.000 hrs	70.000 hrs	70.000 hrs

## NEW STANDARDS REQUIRE NEW LEDS

TM-30 (new color norm): The Illuminating Engineering Society (IES) has published a new Technical Memorandum – TM-30-15 entitled “IES Method for Evaluating Light Source Color Rendition” – that promises to supplant CRI as a color metric. TM-30 relies on separate fidelity and gamut metrics, as well as a set of color samples that is more representative of real-world objects, as opposed to the pastel samples that were primarily used for the baseline CRI metric that was sometimes called Ra. The new color metric is intended to fairly and accurately characterize both LED-based solid-state lighting (SSL) and legacy sources.



### Desaturated

CRI = 80 / R<sub>g</sub> = 92



### Red-Enhanced

CRI = 98 / R<sub>g</sub> = 103

## SPECIAL LEDS AVAILABLE

	CCT	CRI	R9	RF	RG	R15	TLCI	DOWNLIGHTS SMALL		DOWNLIGHTS LARGE		DOWNLIGHTS LARGE		ITEM CODE
								MA	LM	MA	LM	MA	LM	
<b>CRI80</b>	2700K	82	5	82	92	75	69	350 mA	1550	700 mA	2900	1200 mA	4800	51-4028-27-1
<b>CRI80</b>	3000K	82	5	81	93	75	66	350 mA	1625	700 mA	3000	1200 mA	5000	51-4028-30-1
<b>CRI80</b>	4000K	82	5	81	93	74	66	350 mA	1700	700 mA	3400	1200 mA	5700	51-4028-40-1
<b>CRI97</b>	2700K	97	93	96	103	99	97	350 mA	1150	800 mA	x	1400 mA	x	50-3031-27
<b>CRI97</b>	3000K	97	96	95	103	100	97	350 mA	1250	800 mA	2500	1400 mA	3750	50-3031-30
<b>CRI97</b>	4000K	97	96	95	103	100	97	350 mA	1350	800 mA	x	1400 mA	x	50-3031-40
<b>CrispWhite</b>	3000K	90	61	87	102	89	83	350 mA	780	900 mA	2300	1400 mA	3550	51-4029-30
<b>CrispColor</b>	2700K	94	96	93	106	95	93	350 mA	780	900 mA	2350	1400 mA	3550	51-4047-27
<b>CrispColor</b>	3000K	91	93	91	103	96	96	350 mA	825	900 mA	2500	1400 mA	3750	51-4048-30
<b>CrispColor</b>	3250K	93	95	90	101	96	97	350 mA	870	900 mA	2600	1400 mA	3950	51-4049-FN
<b>CrispColor</b>	3500K	95	96	91	102	95	96	350 mA	880	900 mA	2600	1400 mA	4000	51-4050-35
<b>CrispColor</b>	4000K	95	96	90	101	95	96	350 mA	1050	900 mA	2700	1400 mA	4700	51-4051-40
<b>CrispColor</b>	5000K	95	96	88	99	94	95	350 mA	850	900 mA	2800	1400 mA	3800	51-4052-00
<b>Produce</b>	3000K	91	93	91	103	96	96	350 mA	725	900 mA	2500	1400 mA	3300	51-4041-00
<b>Red Meat</b>	1800K	82	81	77	119	95	60	350 mA	515	900 mA	1750	1400 mA	2350	51-4042-00
<b>Marbled Meat</b>	3000K	63	32	78	115	46	72	350 mA	475	900 mA	1600	1400 mA	2150	51-4043-00
<b>Fish</b>	6500K	96	96	89	98	94	96	350 mA	825	900 mA	2800	1400 mA	3750	51-4044-00
<b>Bread &amp; Pastries</b>	2700K	92	54	89	96	86	91	350 mA	770	900 mA	2600	1400 mA	3500	51-4045-00
<b>AtmoSphere</b>	2200K	92	55	90	99	87	88	350 mA	780	900 mA	2350	1400 mA	3550	51-4046-00



## 2700K

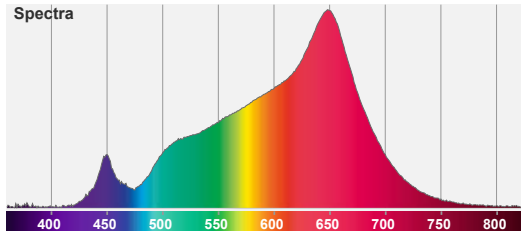
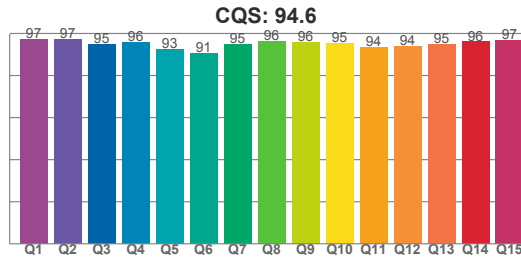
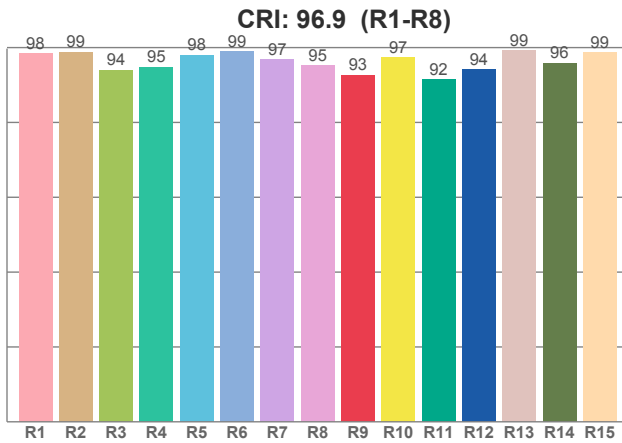

CCT	CRI	CRI R9	TM30 Rf	TM30 Rg	CQS
2700K	96.9	92.7	96.0	102.6	94.6

## 3000K

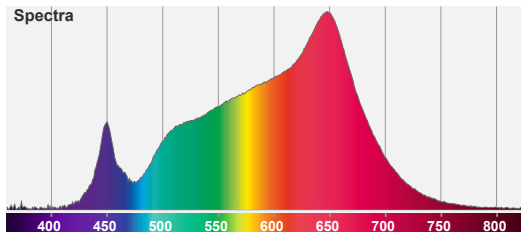
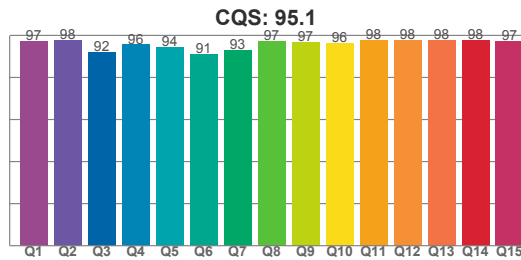
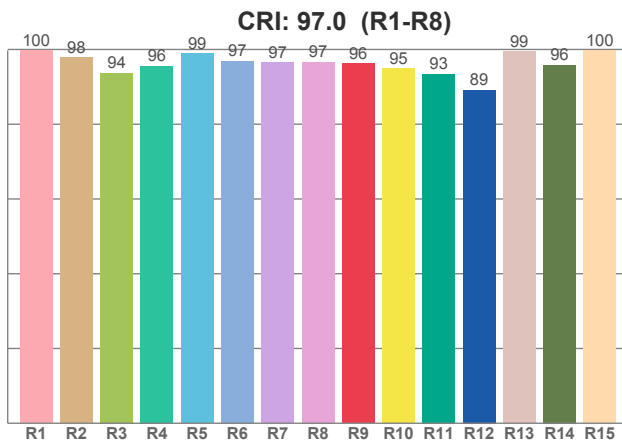

CCT	CRI	CRI R9	TM30 Rf	TM30 Rg	CQS
3000 K	97.0	96.2	95.0	103.3	95.1

## 4000K

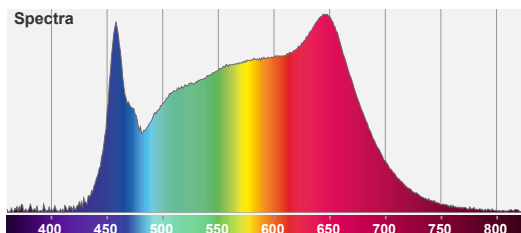
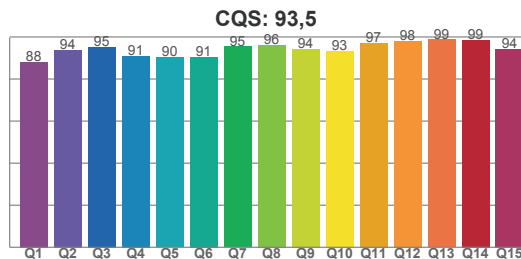
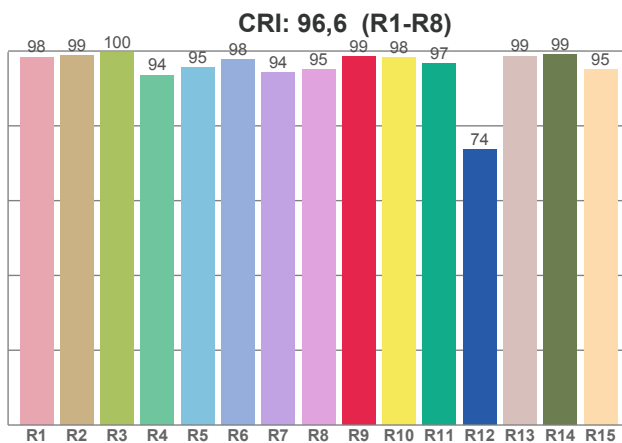

CCT	CRI	CRI R9	TM30 Rf	TM30 Rg	CQS
4000K	96.6	98.5	88.3	96.2	93.5